



P.O. Box 4173 Glendale CA 91202
www.GlendaleHistorical.org

February 27, 2024

Glendale City Council
City of Glendale
613 East Broadway
Glendale, CA 91206

RE: February 27, 2024 Special City Council Meeting

Item 1. Community Development, re: Contract Amendment... Additional Design Services for the Preservation and Reuse of City Owned Property Located at the Former Rockhaven Sanitarium - 2713 Honolulu Avenue (APNs: 5610-024-900 thru 910) (Contract #8001911)

Dear Mayor Brotman and Glendale City Council Members,

The Glendale Historical Society (TGHS) strongly supports preservation and adaptive reuse of historic resources in Glendale. Our more than 1,300 members are strongly engaged and dedicated to this mission.

We appreciate the opportunity to provide comments on the proposed "Rockhaven Project" at Rockhaven Sanitarium Historic District that is currently under consideration. Our professionally qualified members and Board of Directors have in the past and will continue to provide professional guidance to the City of Glendale on this project and expect to be involved in its future, to identify and encourage a constructive path forward that would retain, protect and appropriately honor the remarkable significance of the Rockhaven Sanitarium Historic District.

It is our understanding that the SWA proposal will address the following areas:

- 1) Pines Cottage renovation for Museum
- 2) Renovation of historic grounds
- 3) Off-site parking feasibility

First, TGHS would like to reiterate that the landscape is protected as part of its National Register nomination. Per staff's report, there appears to be consensus on this point. The Secretary of the Interior's Standards for the Treatment of Historic Properties with Guidelines for the Treatment of

The Glendale Historical Society (TGHS) advocates for the preservation of important Glendale landmarks, supports maintaining the historic character of Glendale's neighborhoods, educates the public about and engages the community in celebrating and preserving Glendale's history and architectural heritage, and operates the Doctors House Museum. TGHS is a tax-exempt, not-for-profit 501(c)(3) organization, and donations to TGHS are tax-deductible to the extent permitted by law.

Cultural Landscapes was prepared by the National Park Service as part of their Cultural Landscape Guidance Documents for Cultural Resource Stewardship and Partnerships in 1996. It is applicable to this project and contains standards and guidelines for the treatment of cultural landscapes. That means for this project, any landscape materials that must be replaced, as closely as possible to the original, not merely replacing plants with drought tolerant plant material as described. Because records for this property do exist, there is a clear record to use for any necessary replacement plans.

Second, TGHS believes that all historic structures identified in the National Register Nomination should be in scope for this phase. There are discrepancies between the Historic District map as outlined in the National Register Nomination (Figure 2, below) and the SWA work plan (Figure 1, below).

- The SWA work plan (Figure 1) excludes Building 16 (Figure 2)
- Building A in the SWA work plan (Figure 1) appears out of scope for this project, although it is a contributing historic structure

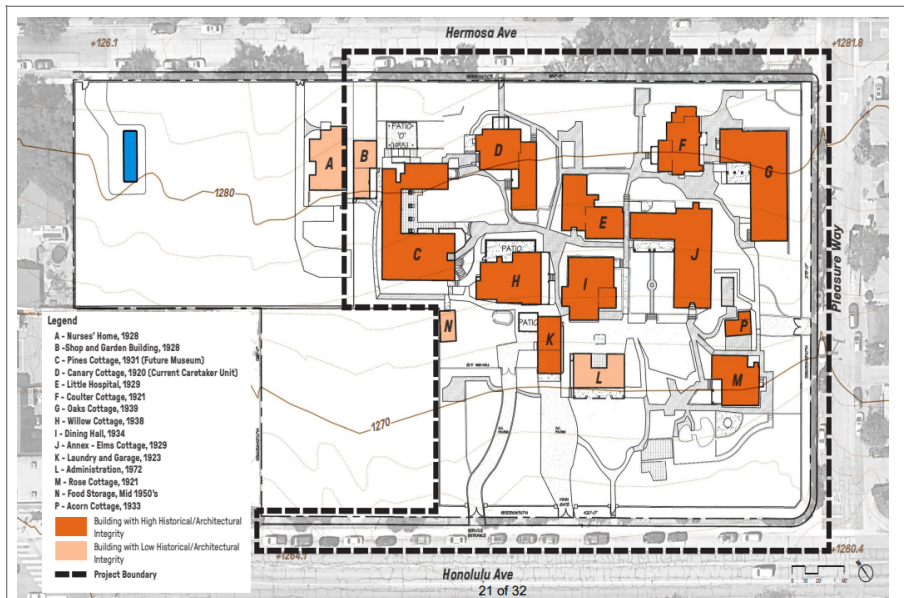

Figure 1: Rockhaven [Sanitarium Historic District] Building Map. Source: SWA 2024.

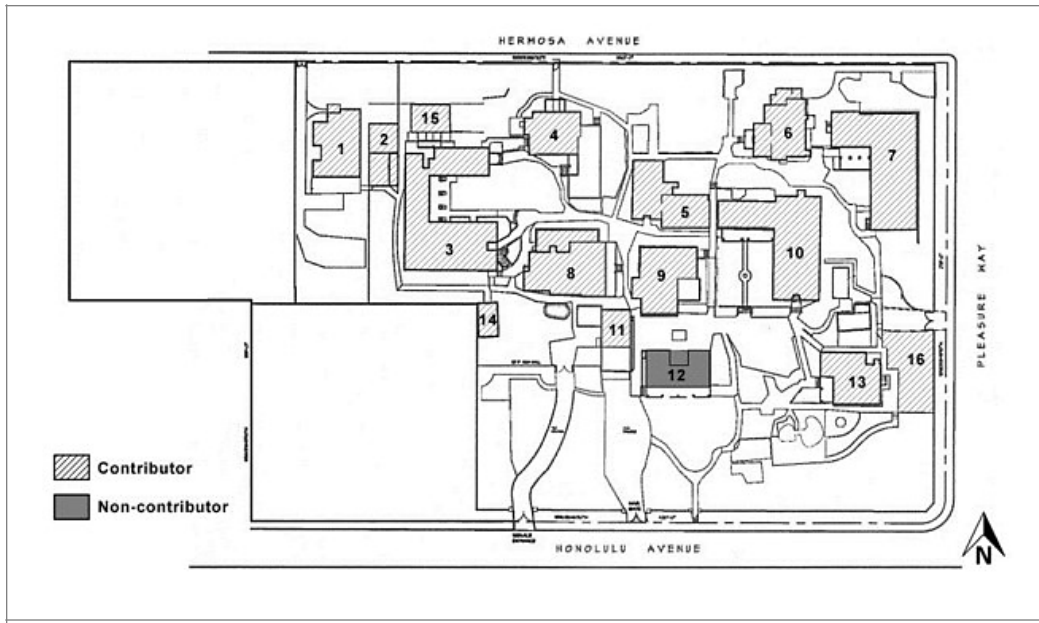

Figure 2: Rockhaven Sanitarium Historic District, Sketch Map/District Contributors and [single] Non Contributor. Source: National Register nomination, Figure 3, 2016.

TGHS respectfully asks that SWA and the City engage with key stakeholders, specifically TGHS and Friends of Rockhaven prior to July 2024 (target date for concept design), and include any feedback in their eventual proposals. Our organizations spend countless hours of resource and support into advocating and caring for some of Glendale’s most precious historic resources. Our hope is that this is a truly collaborative process and the final proposal would have the firm support from key stakeholders.

Respectfully,

John Schwab-Sims
 President
 The Glendale Historical Society

cc: Suzie Abajian, City Clerk
 Bradley Calvert, Director of Community Development
 Jay Platt, Senior Urban Designer
 Roubik Golonian, City Manager
 Anthony Portantino, CA State Senator

